

MTS
YOKE

Instruction Manual
Bedienungsanleitung
Mode d'emploi

PARTS

[dimensions in mm / different scales]
No extra or spare parts listed!

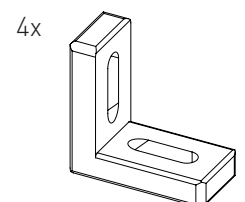
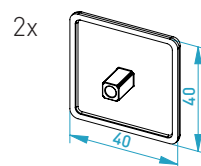
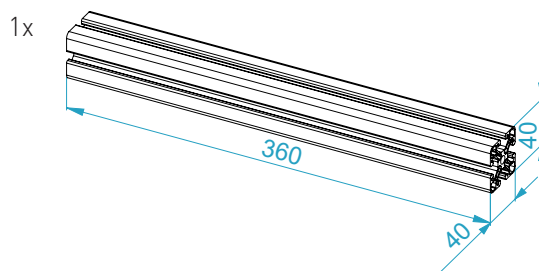
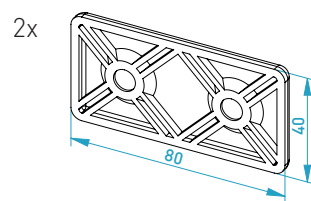
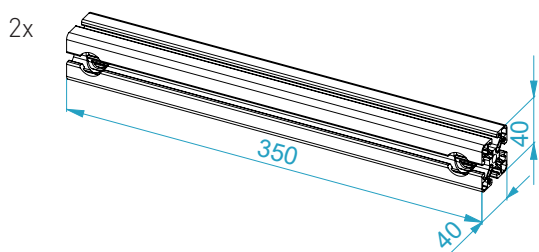
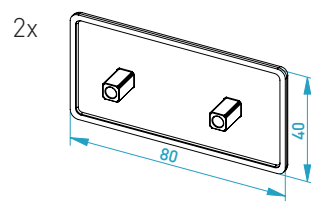
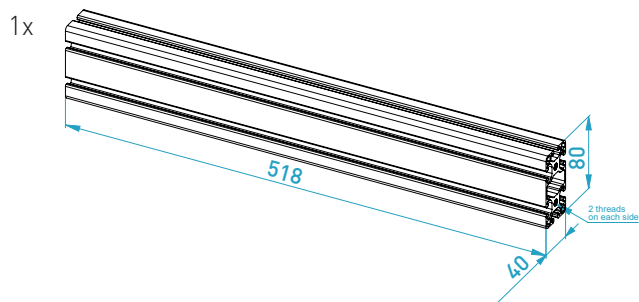
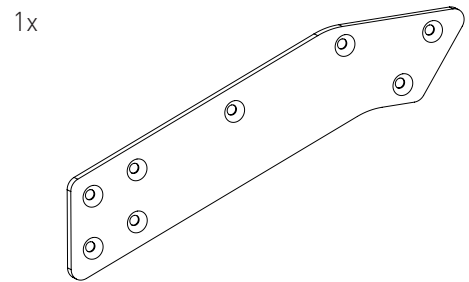
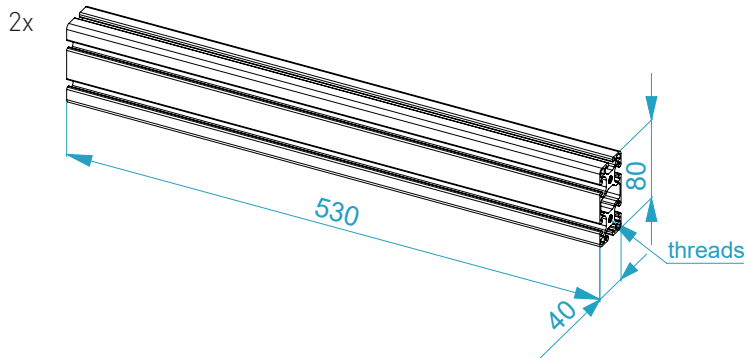
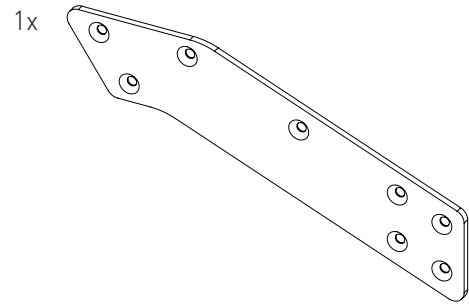
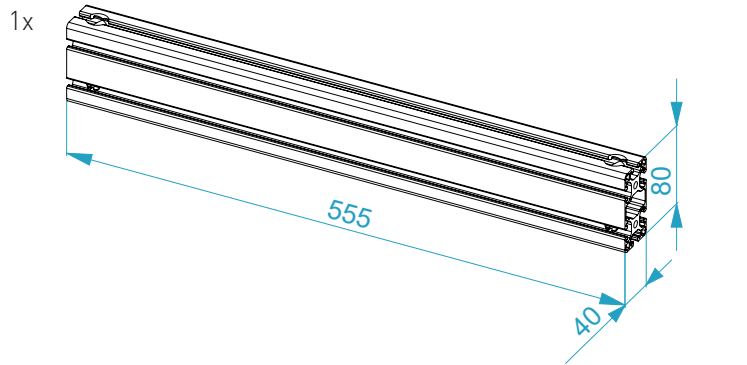

BAG 1

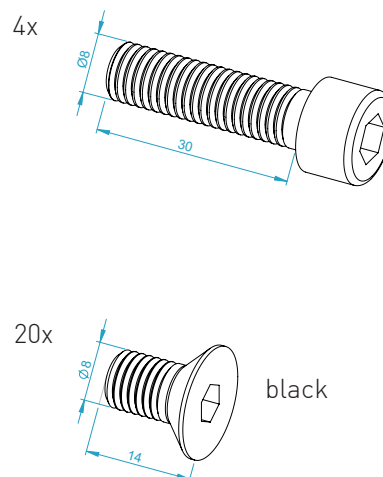
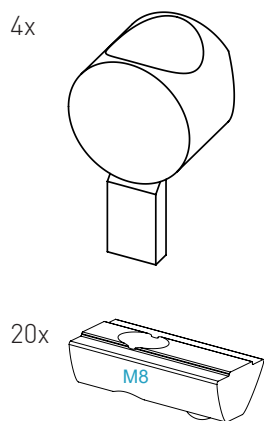

BAG 2

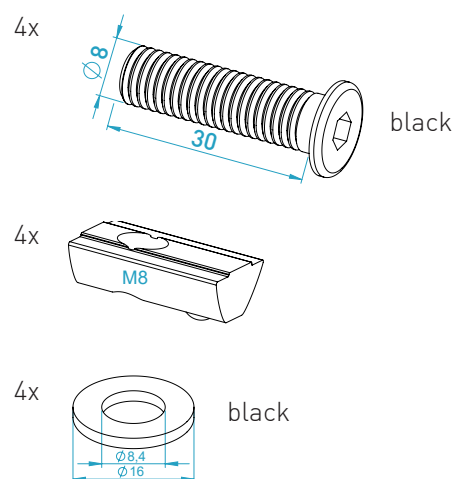
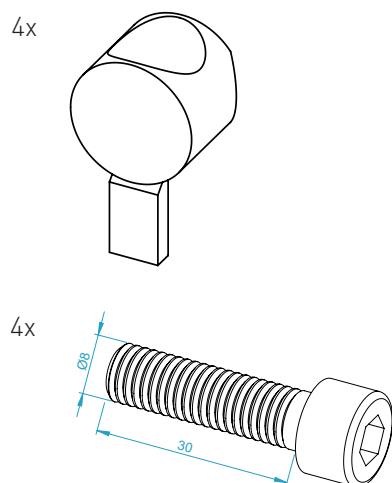

BAG 3 with parts for yoke assembly

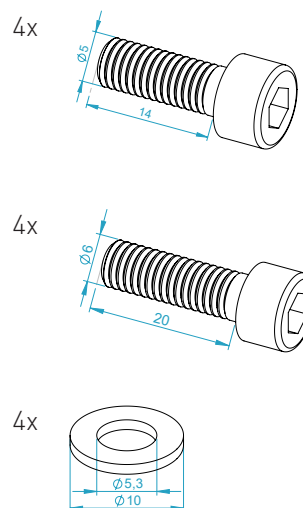
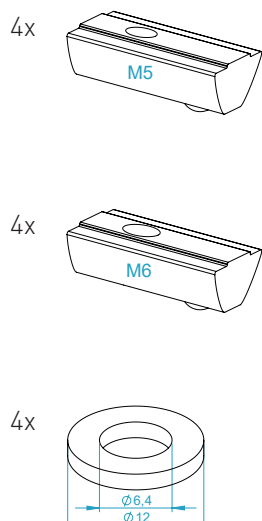

PRE-ASSEMBLED

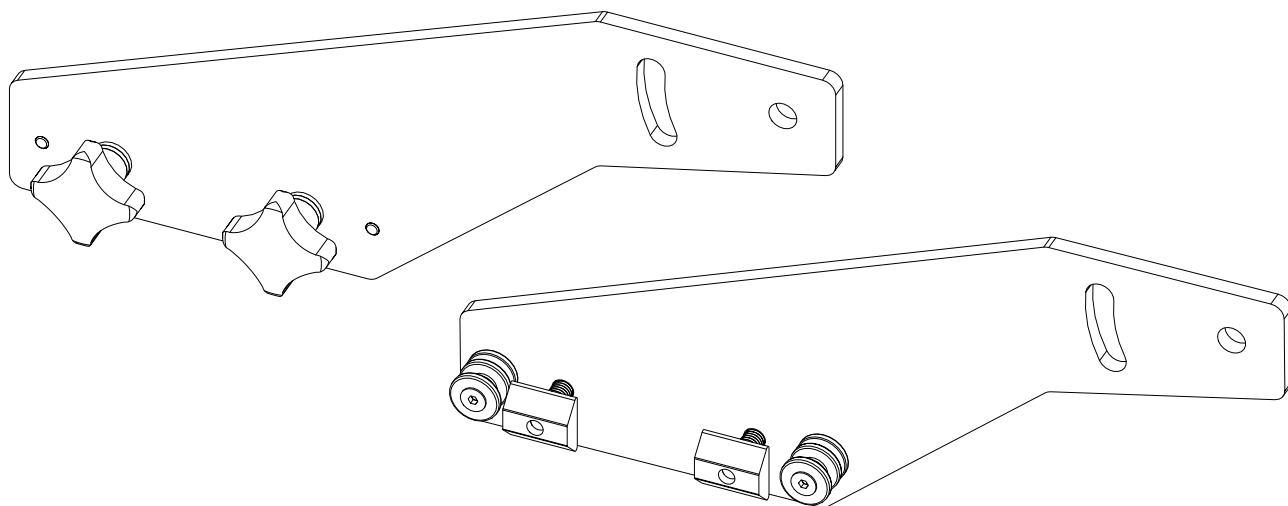

with this parts:

2x

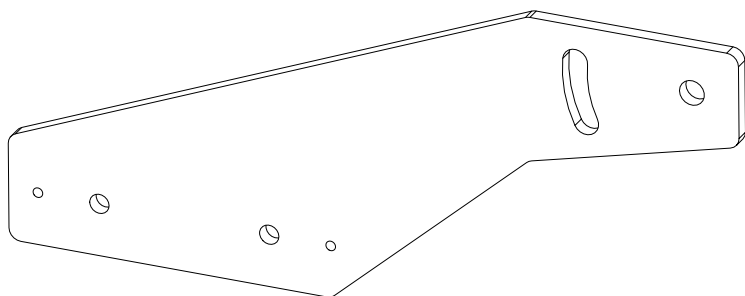

4x

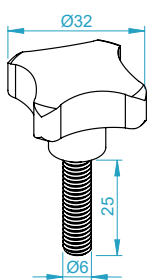

8x

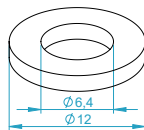

4x

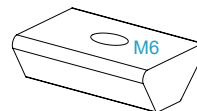

4x

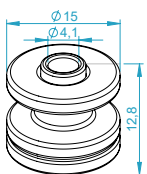

4x

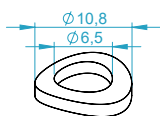

4x

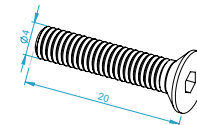

ASSEMBLY

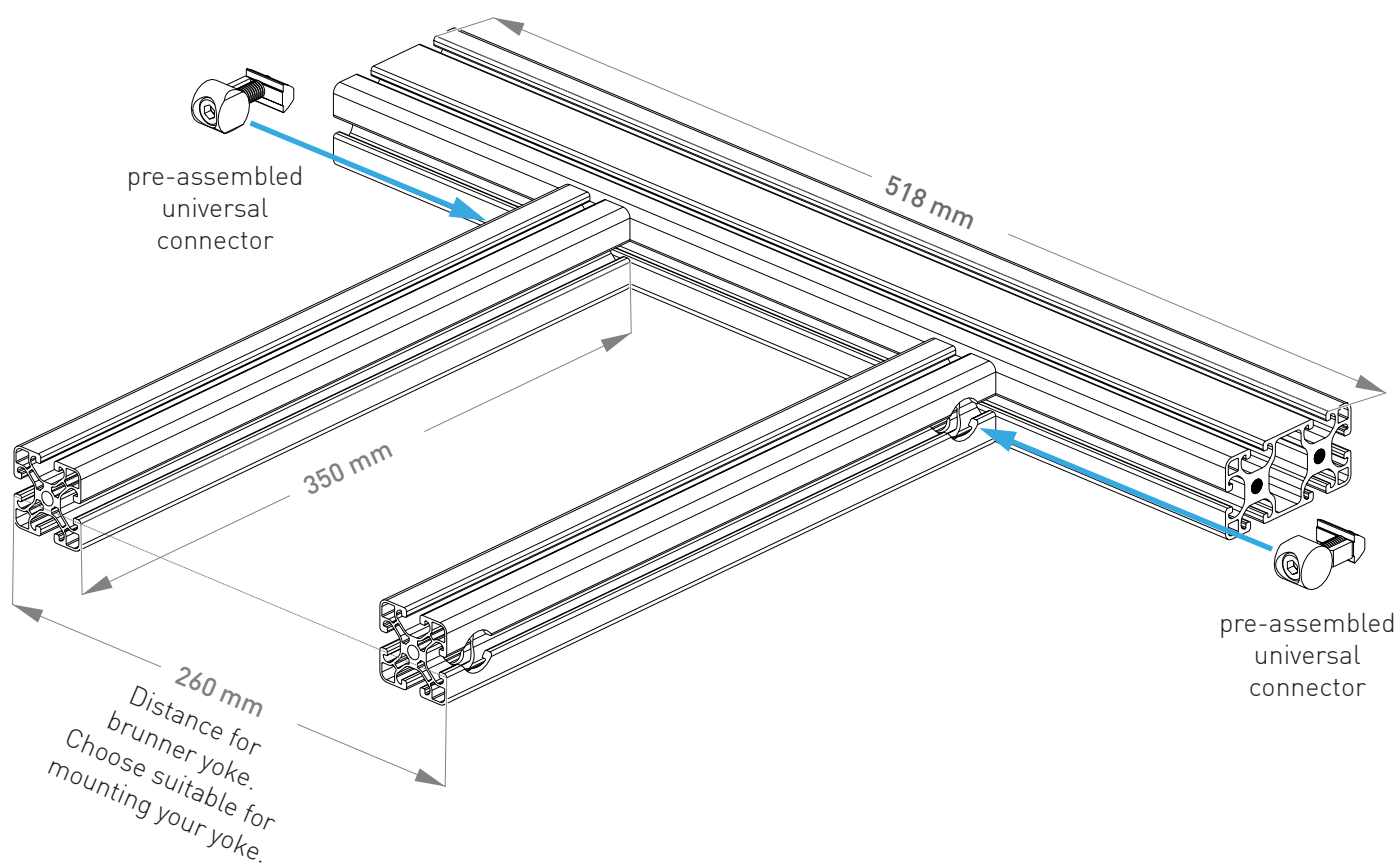
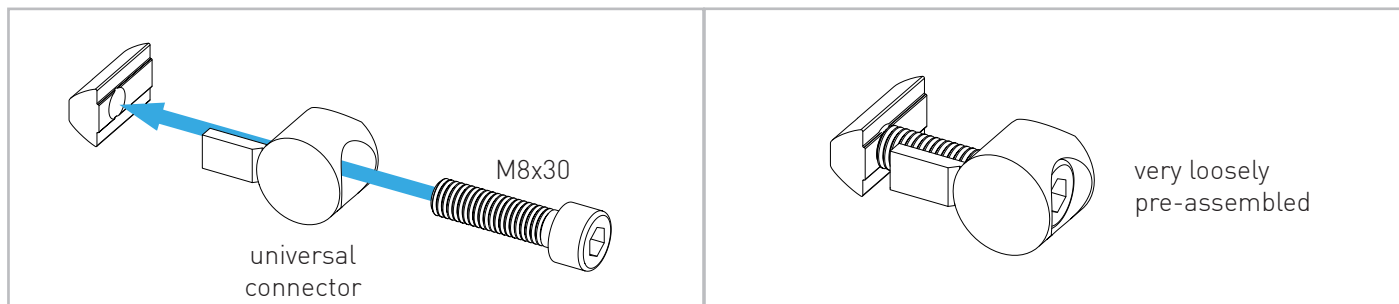

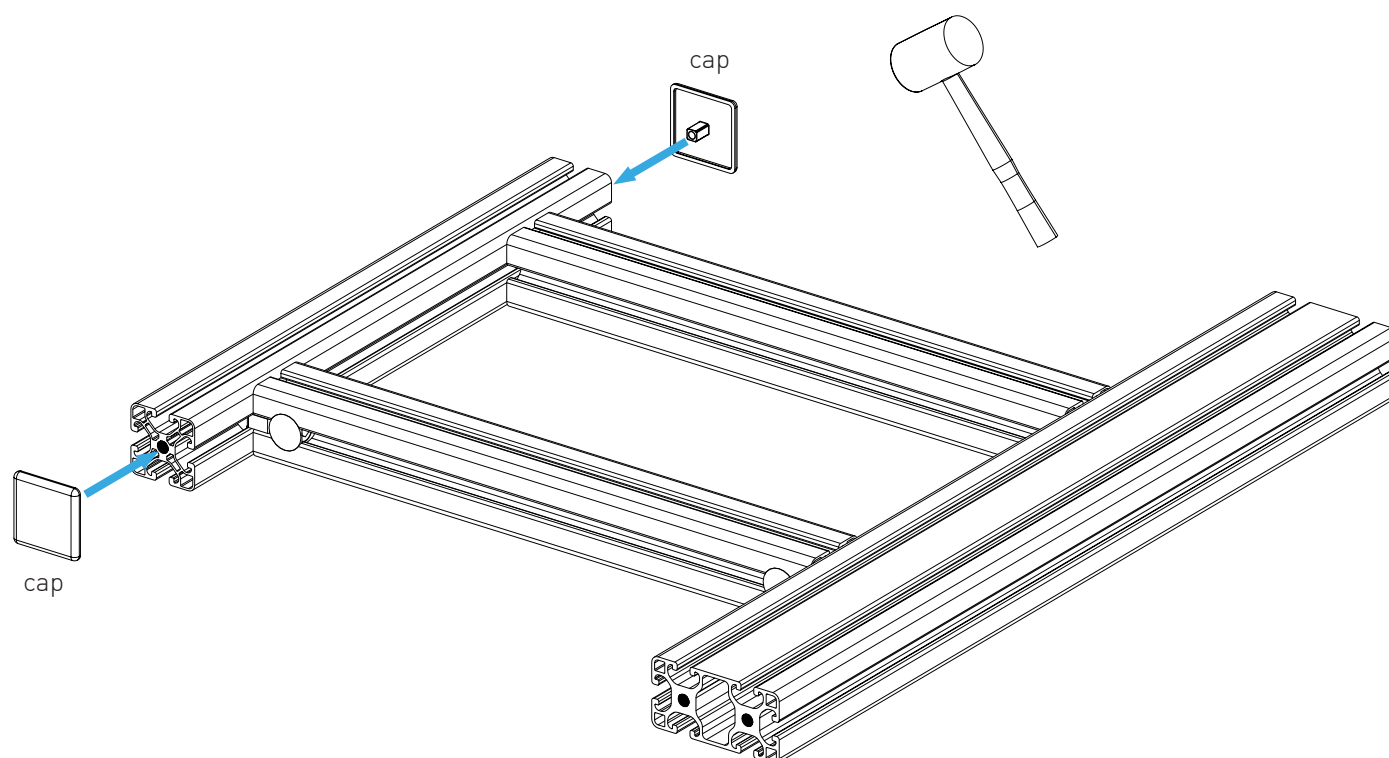
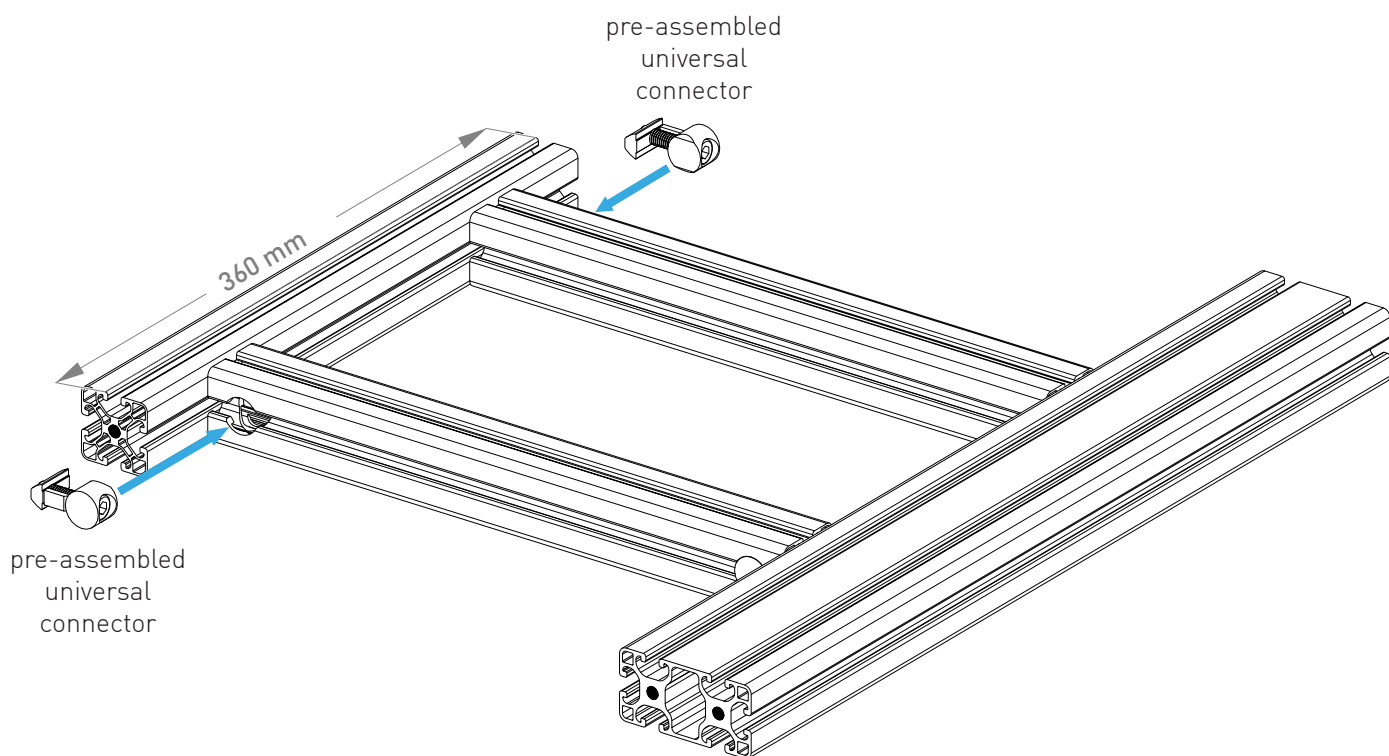

USUALLY PRE-ASSEMBLED

2x

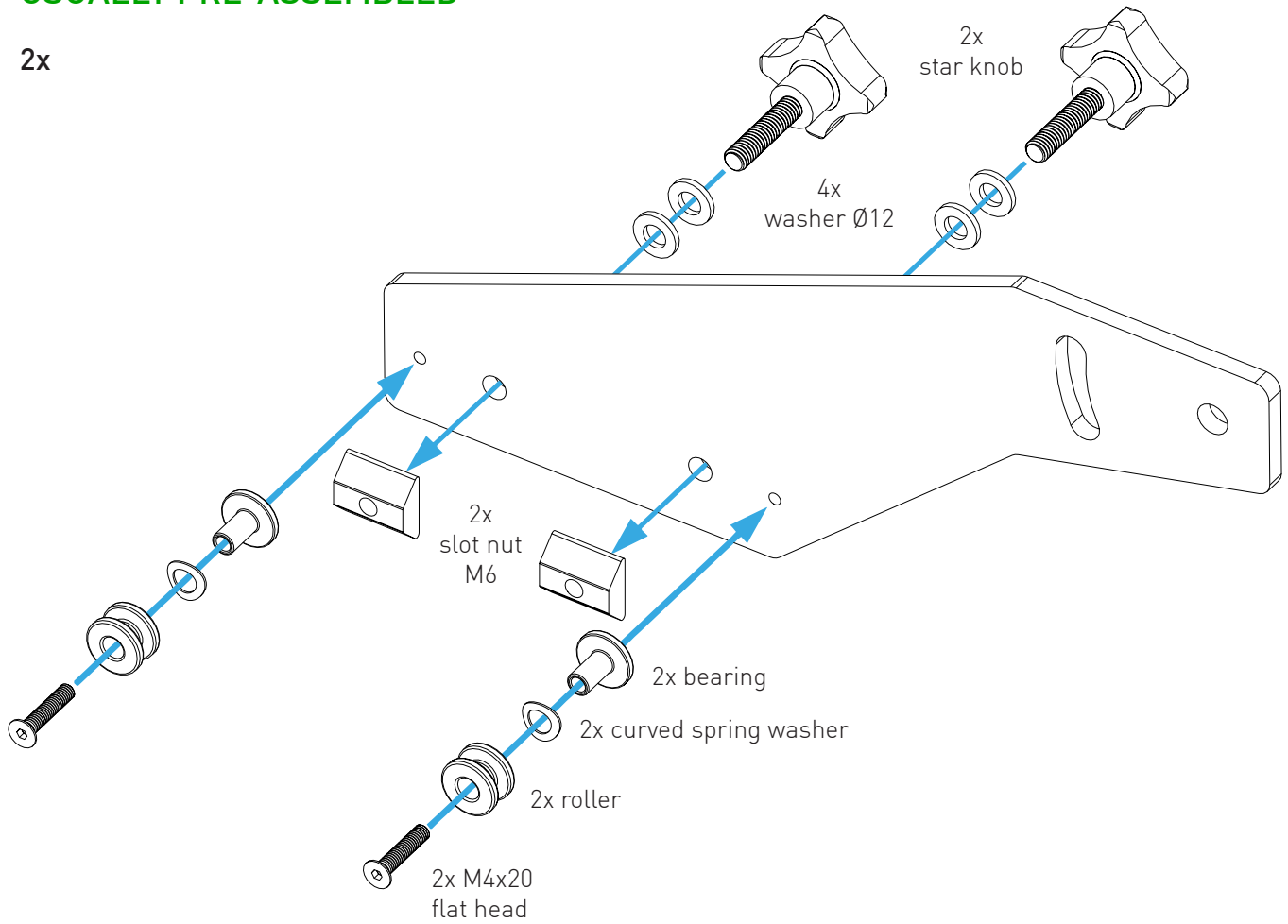

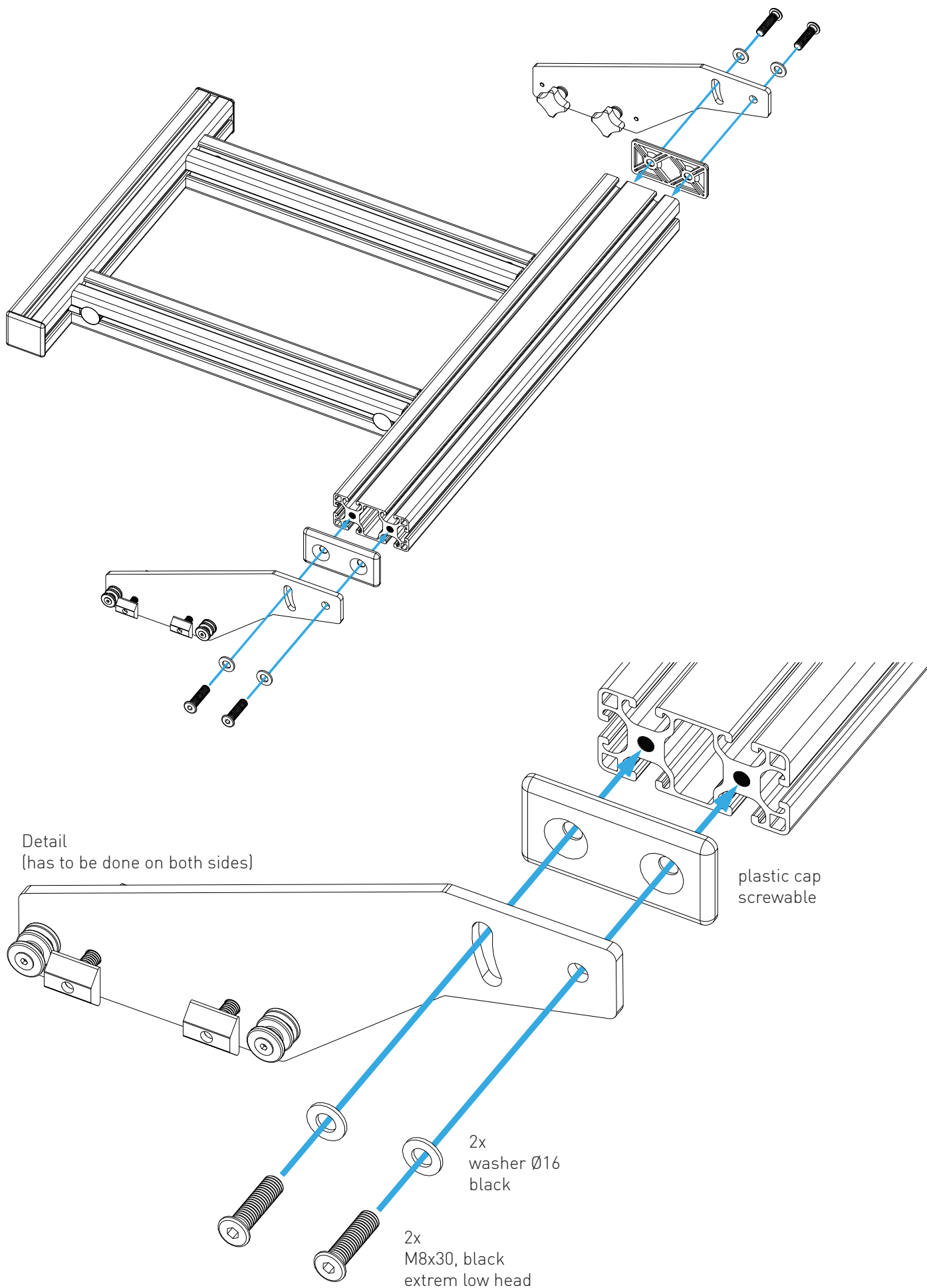

Use a plan surface
for assembly.

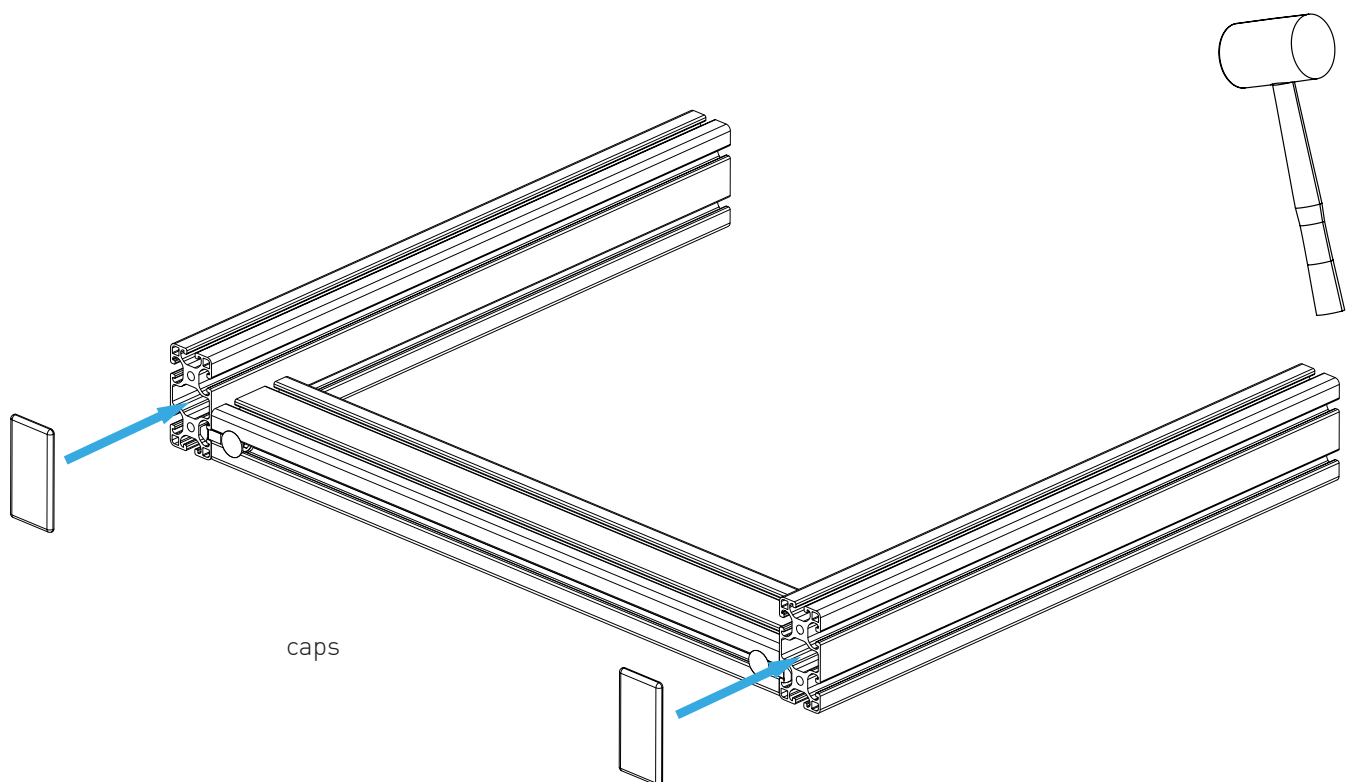
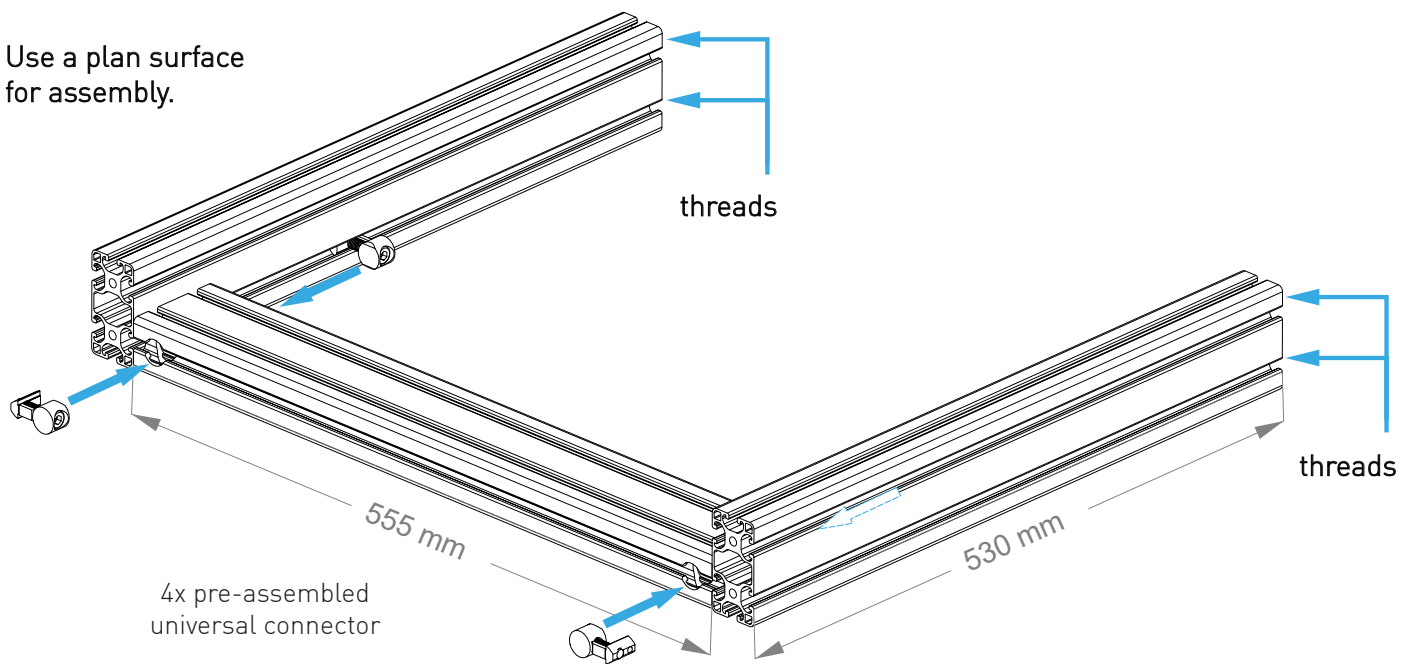

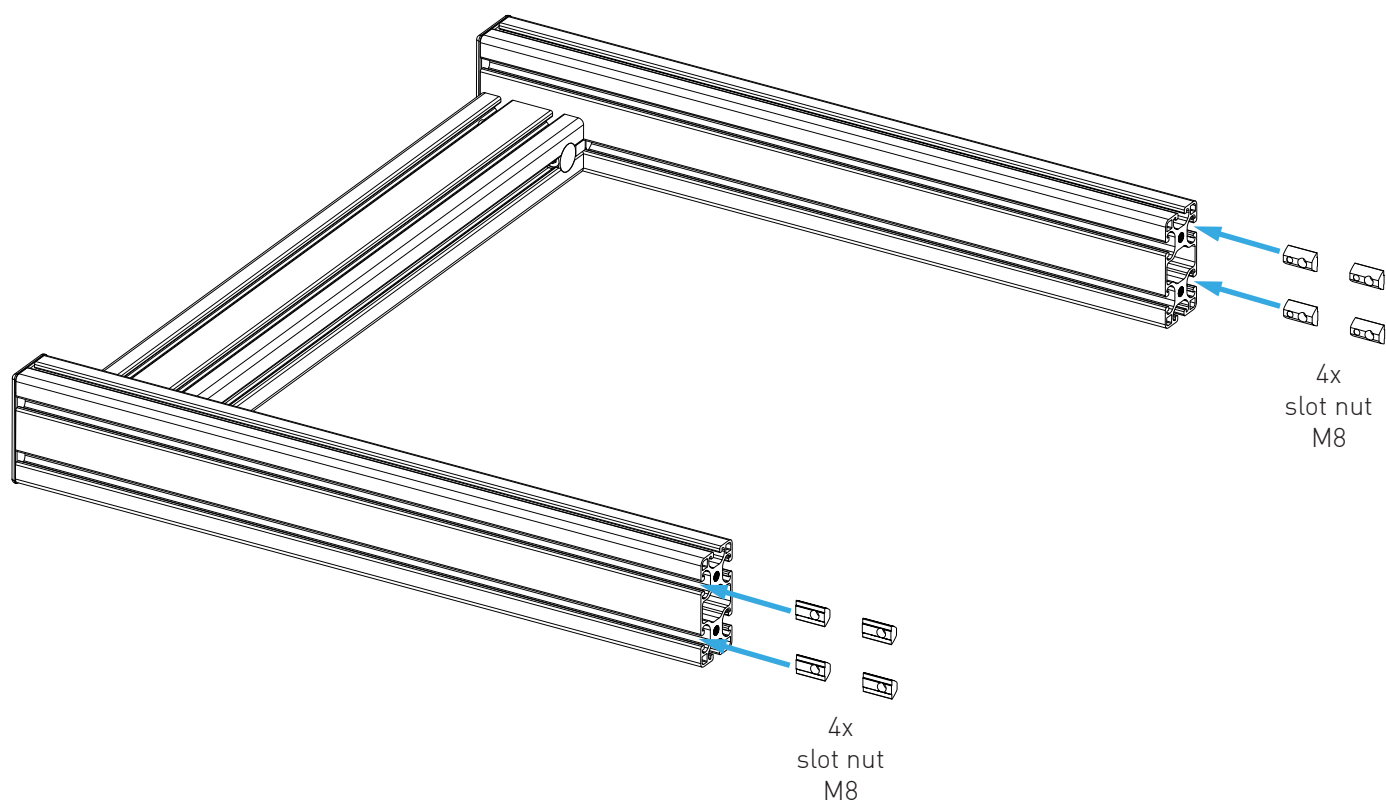

on both sides

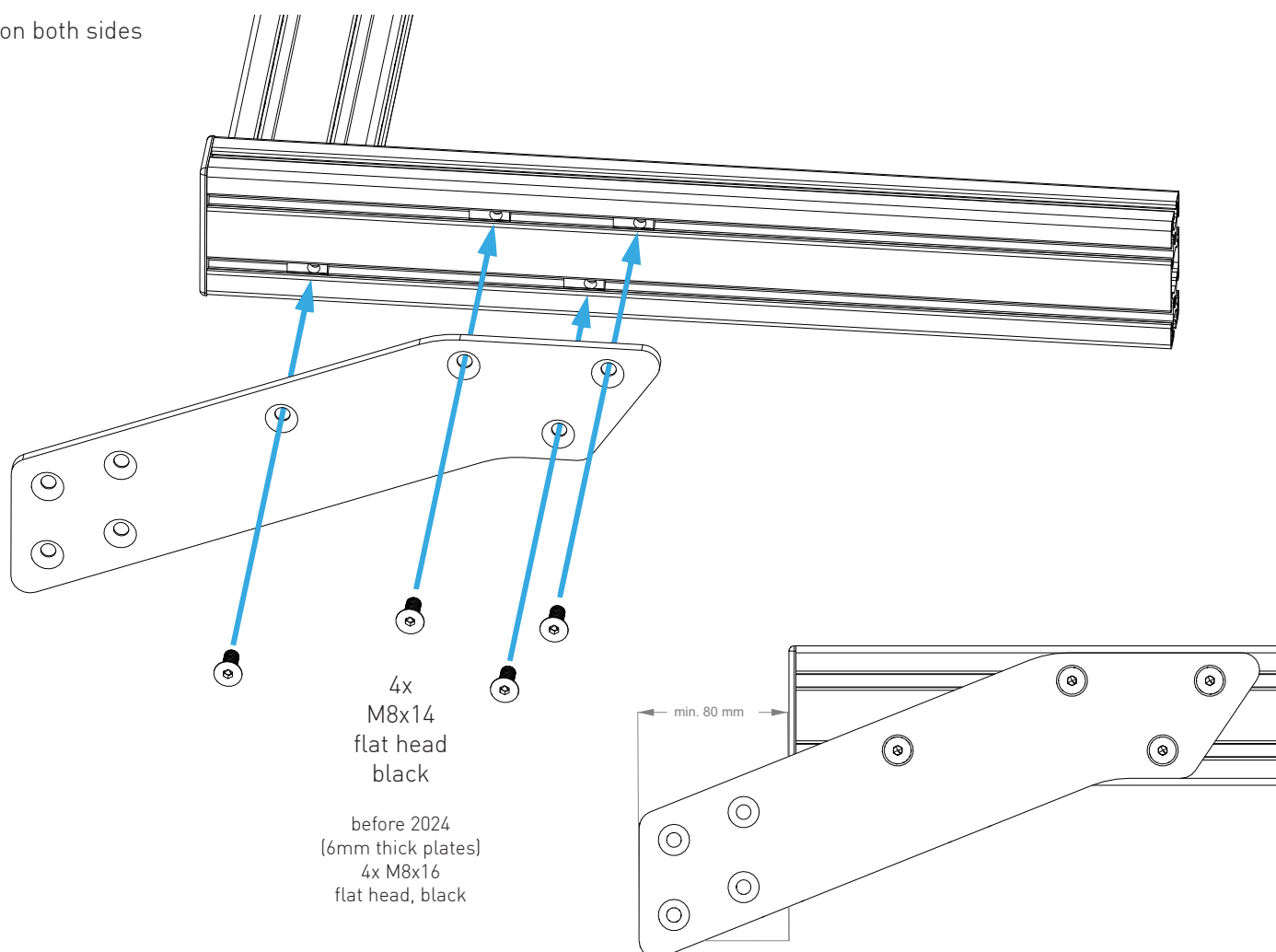

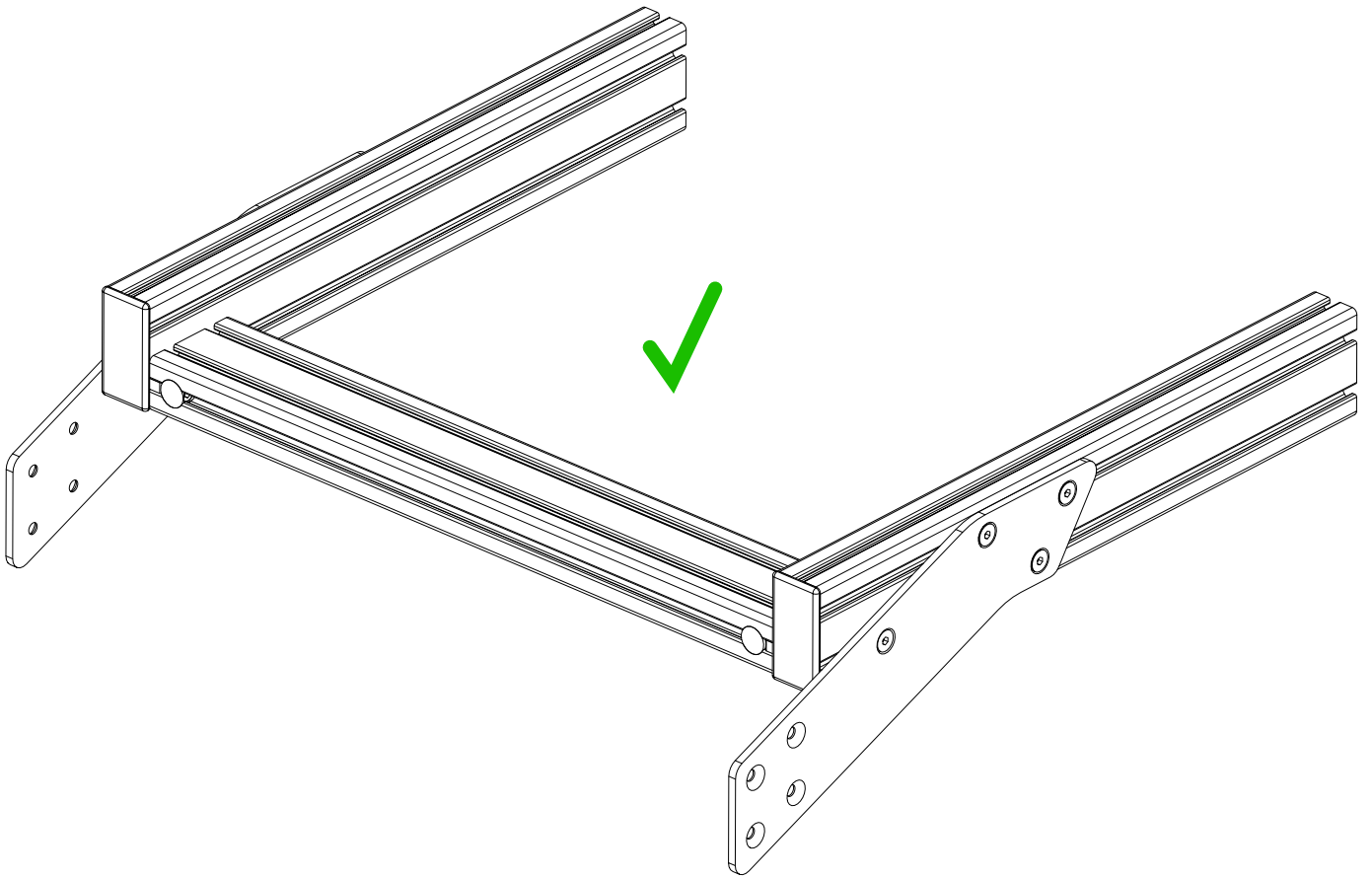

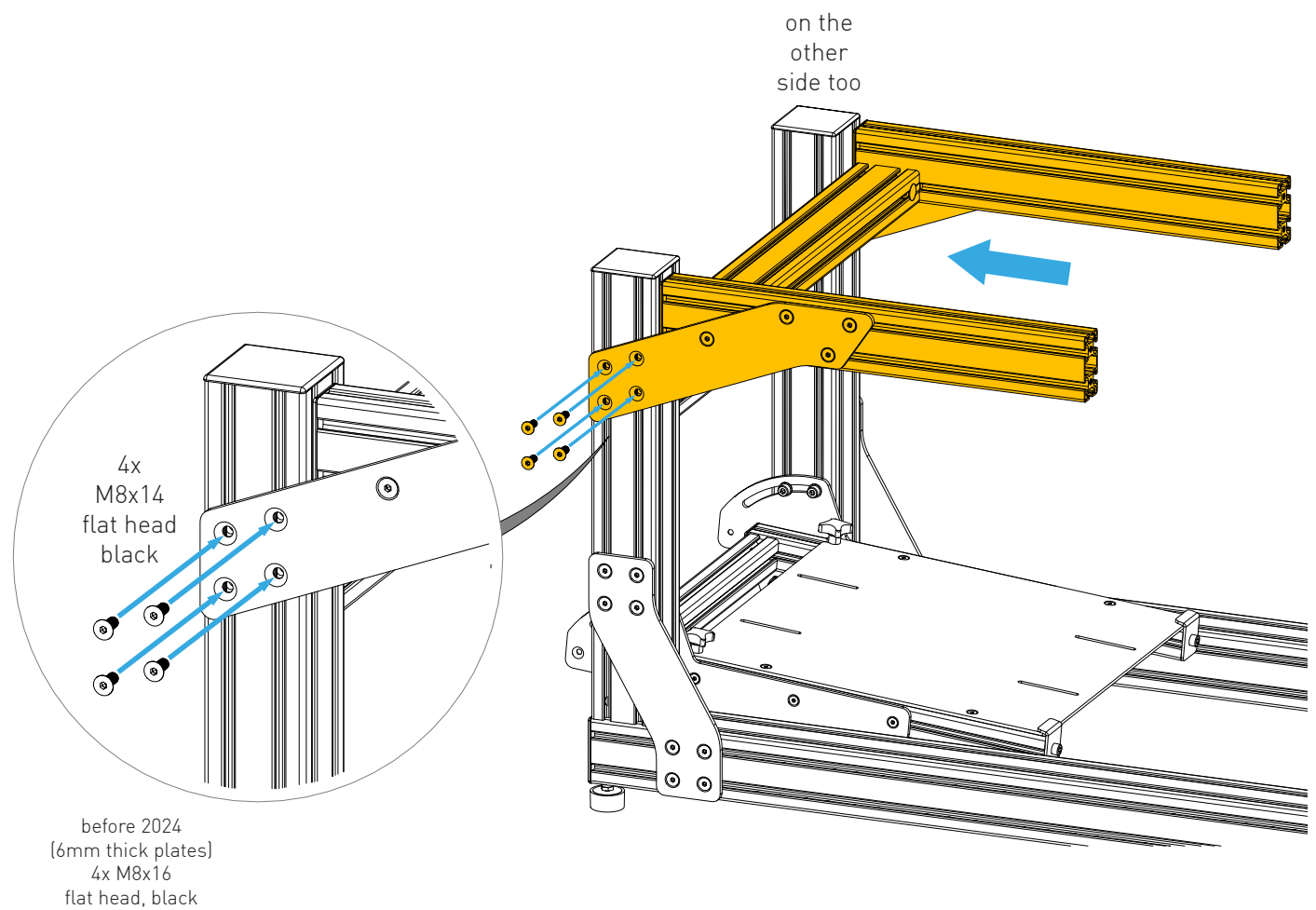
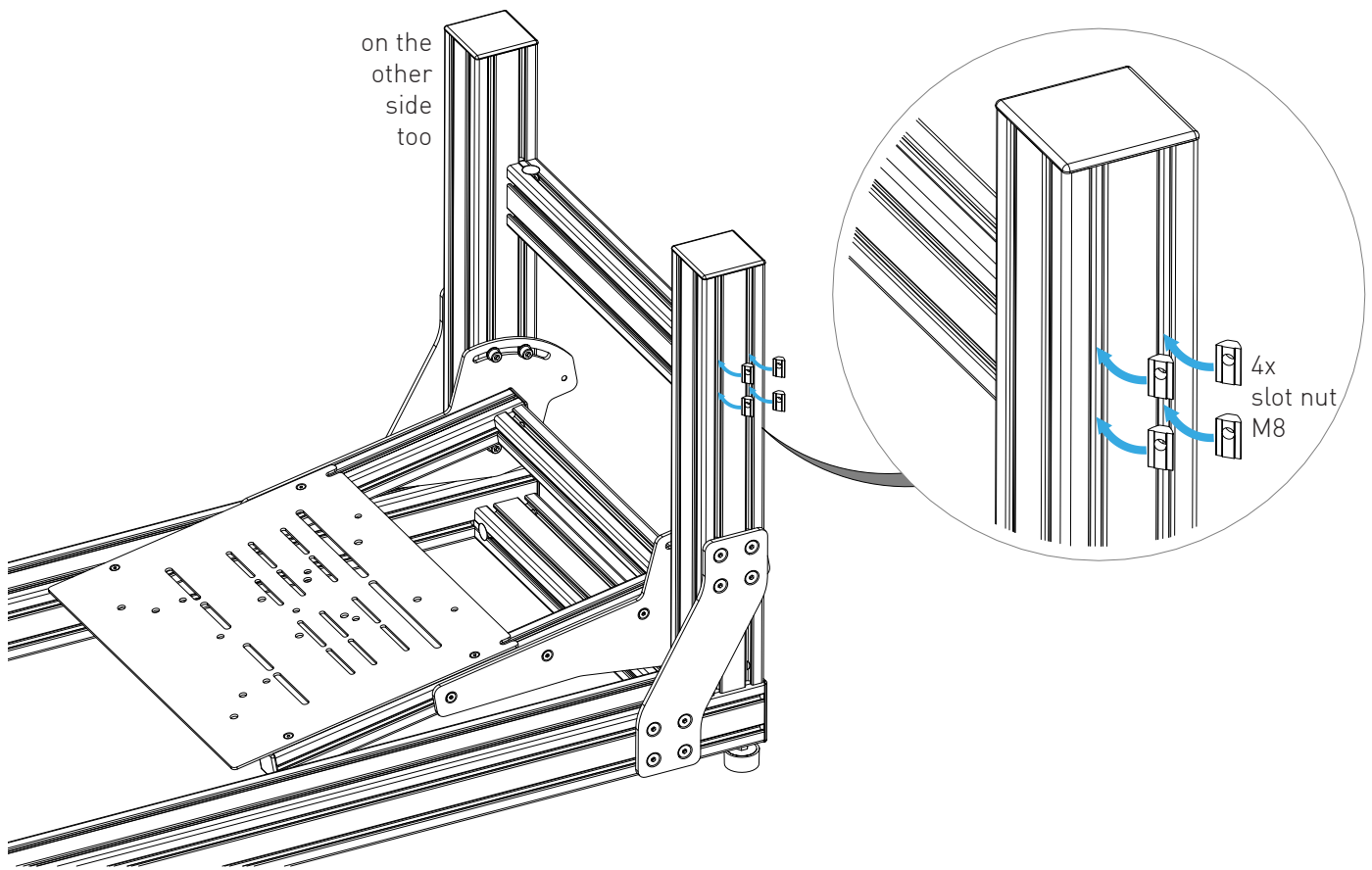

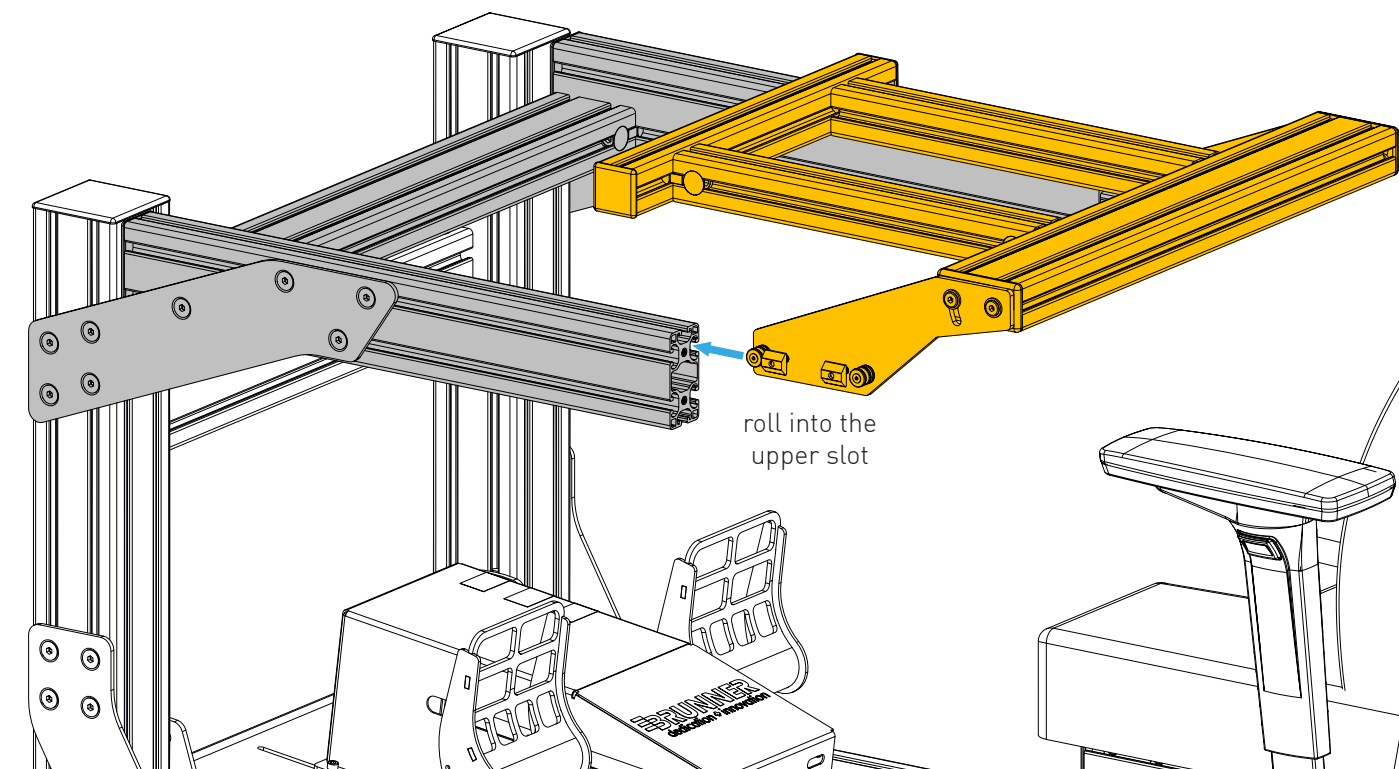

detail views

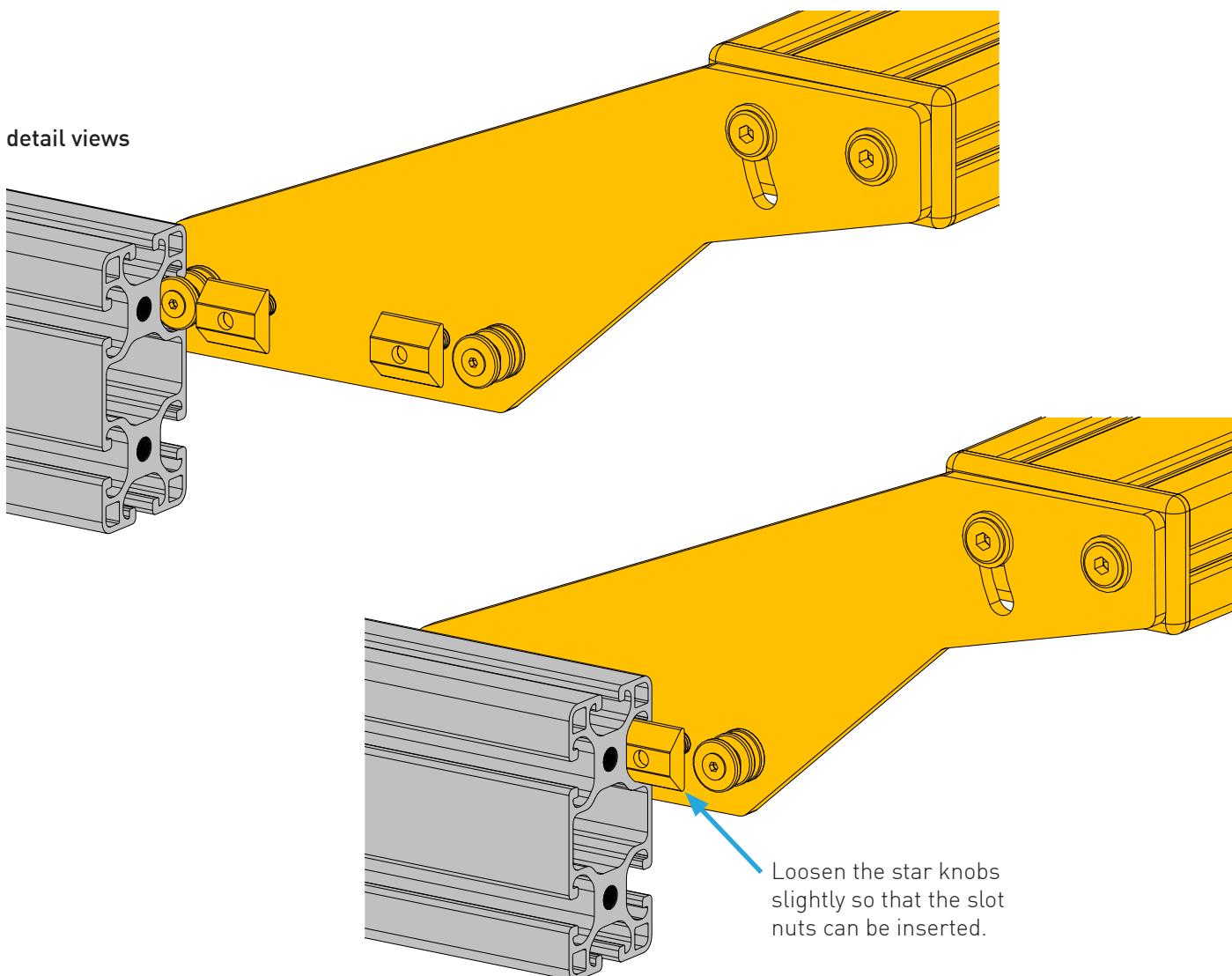

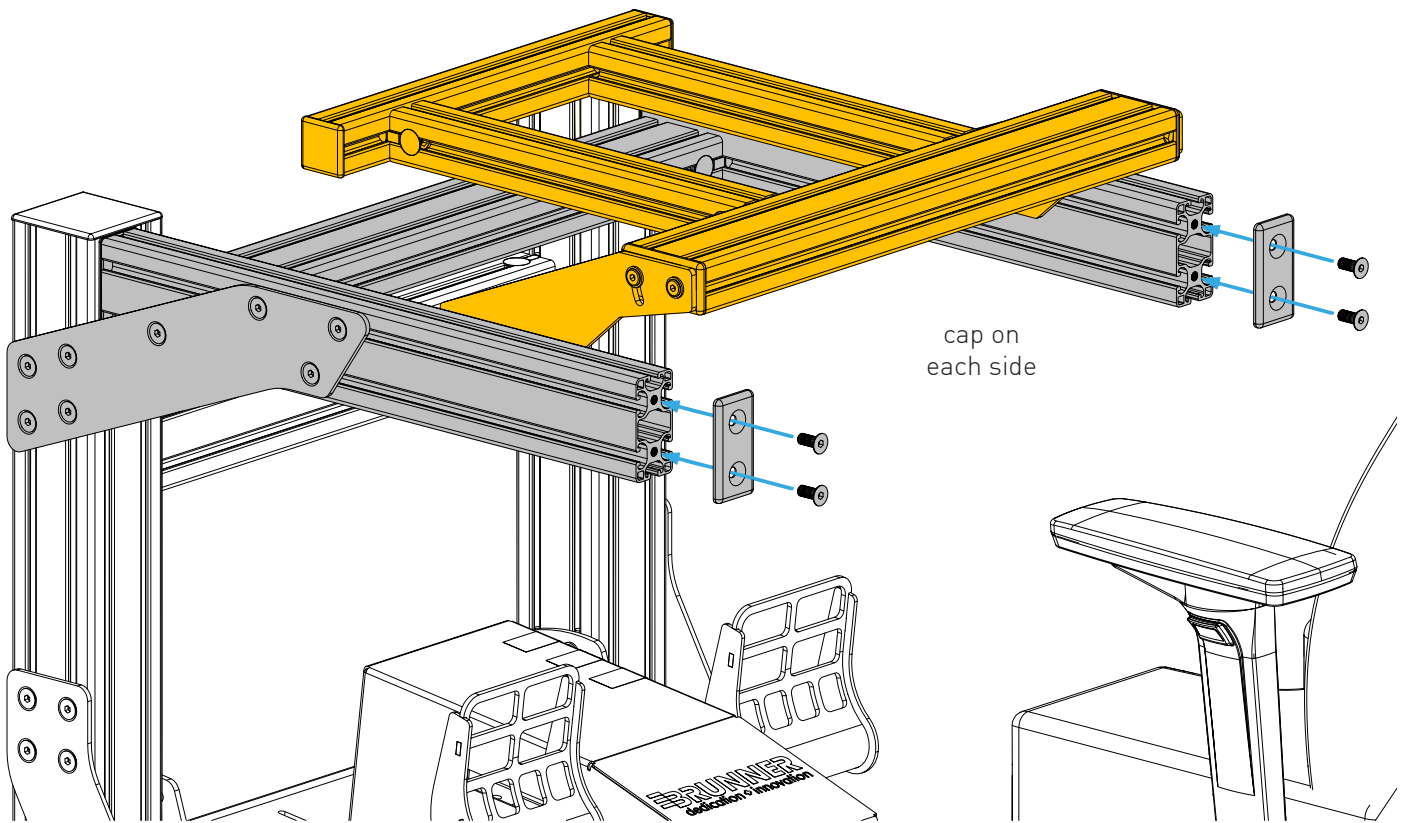

detail

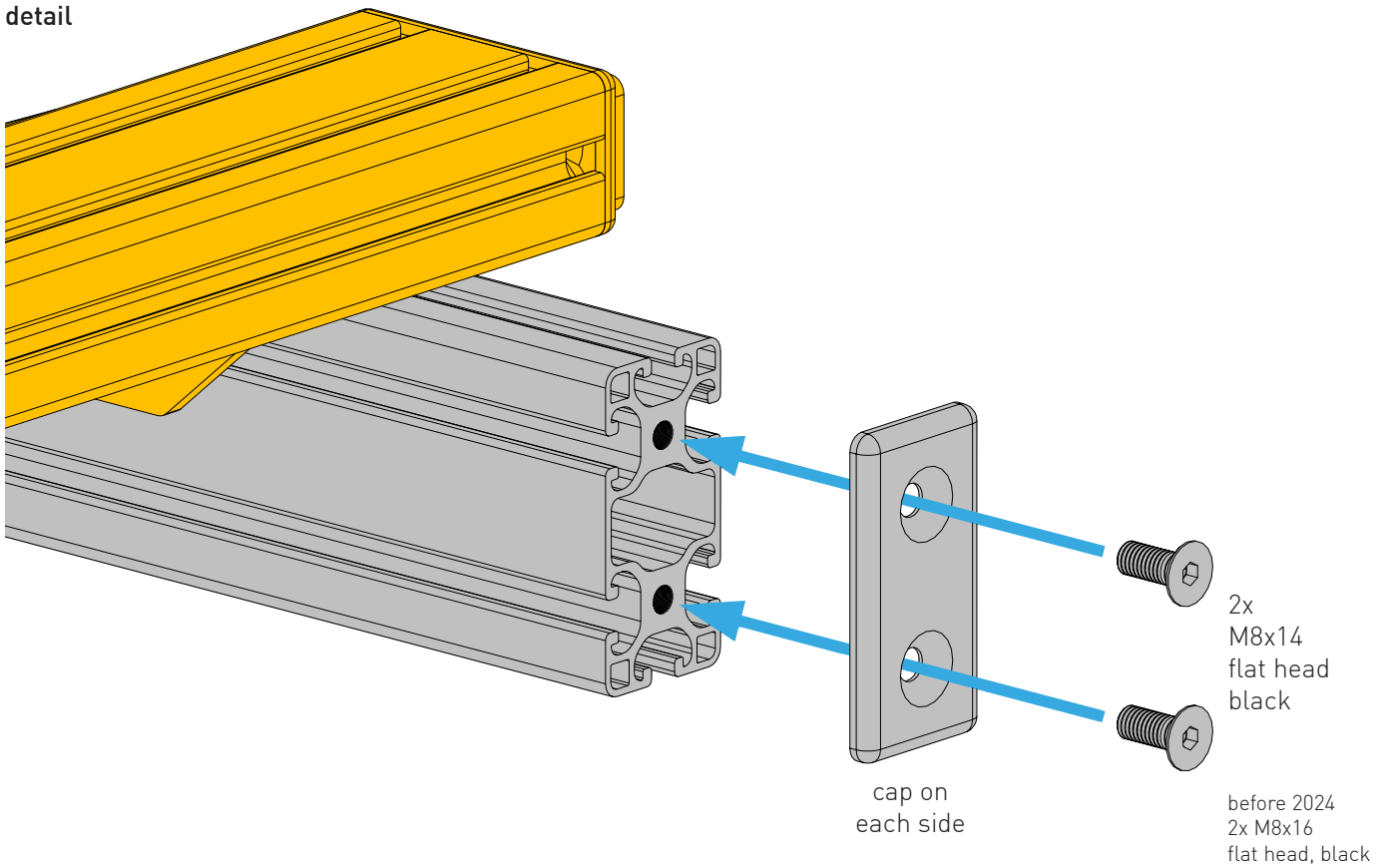

ASSEMBLING A BRUNNER YOKE

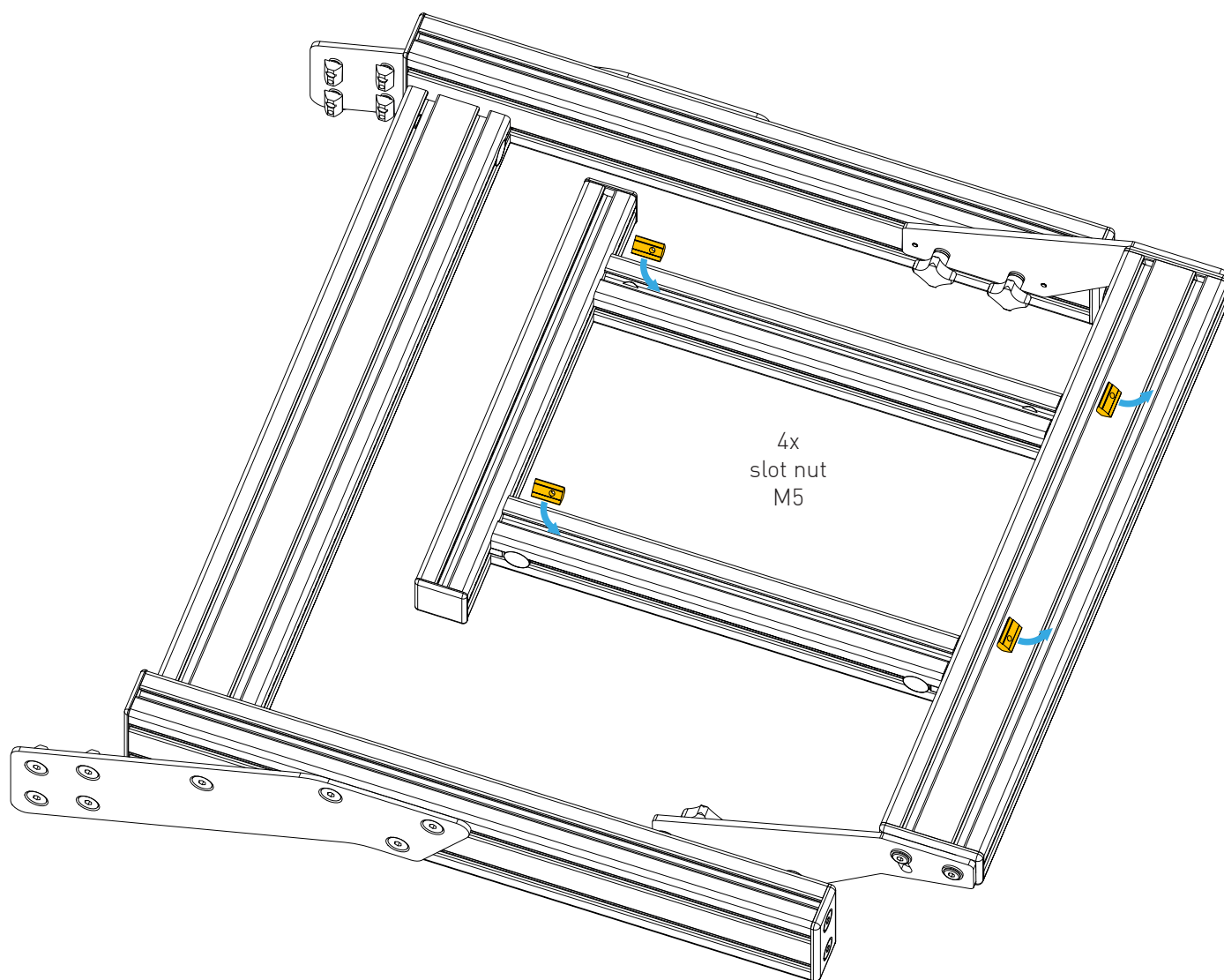

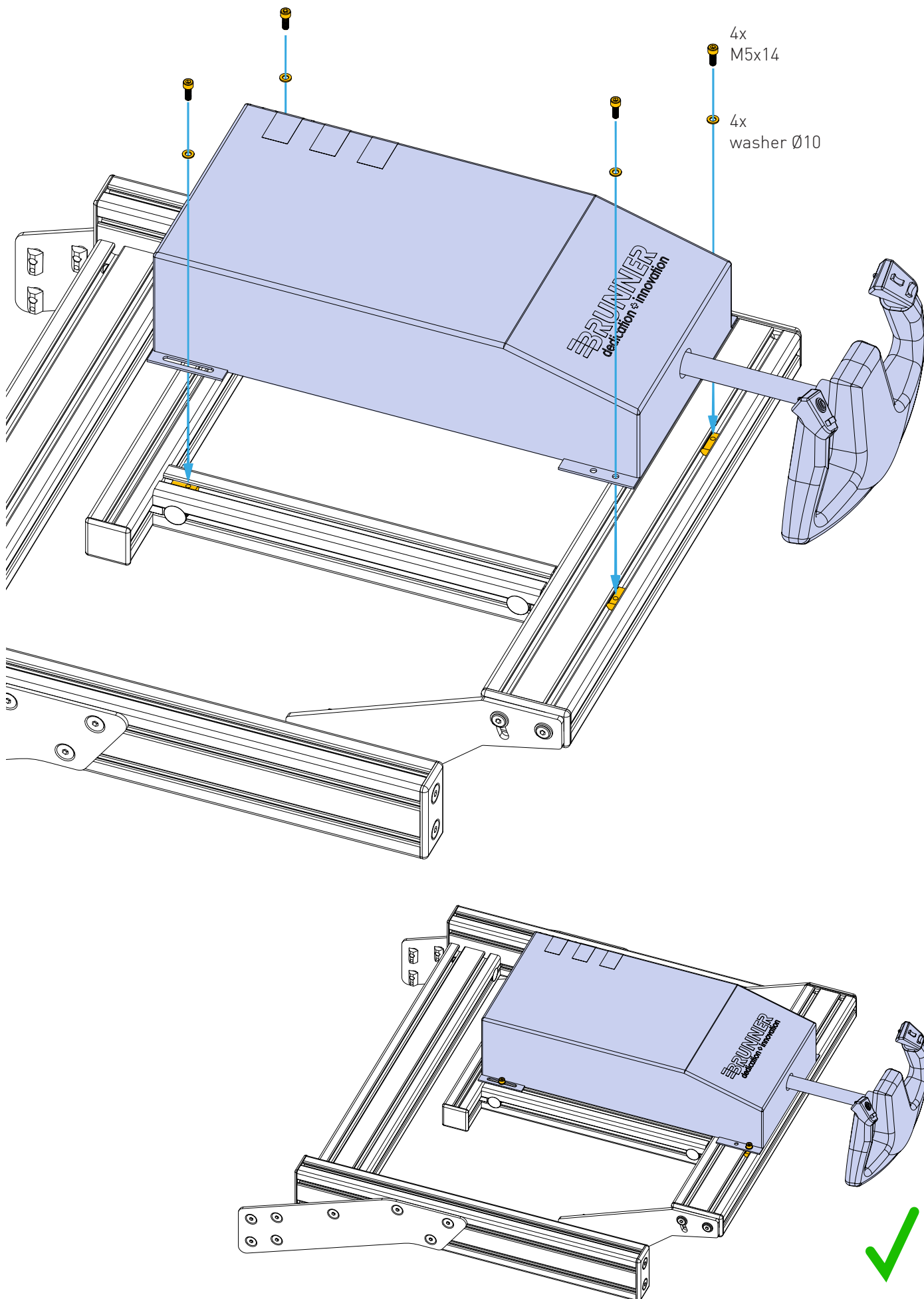

UNIVERSAL ASSEMBLING WITH BRACKETS

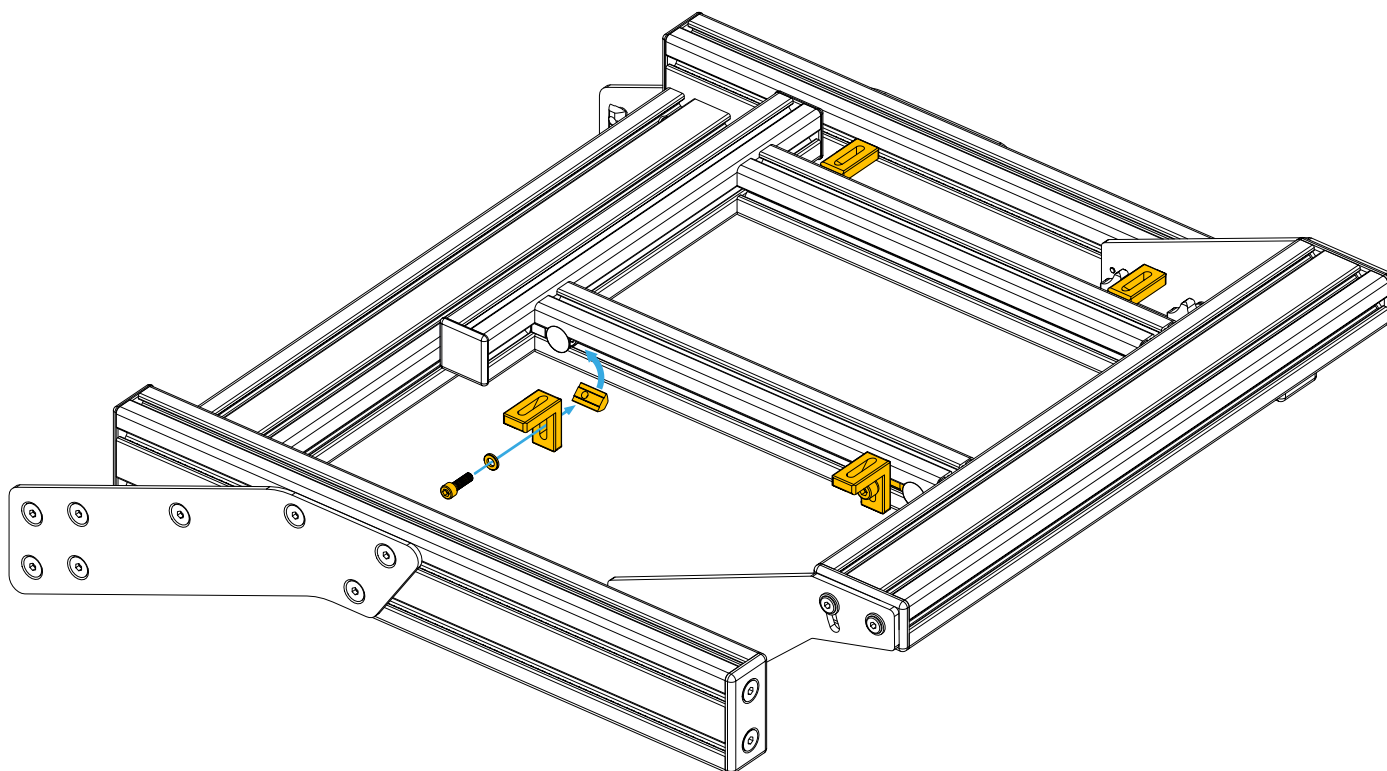

detail view

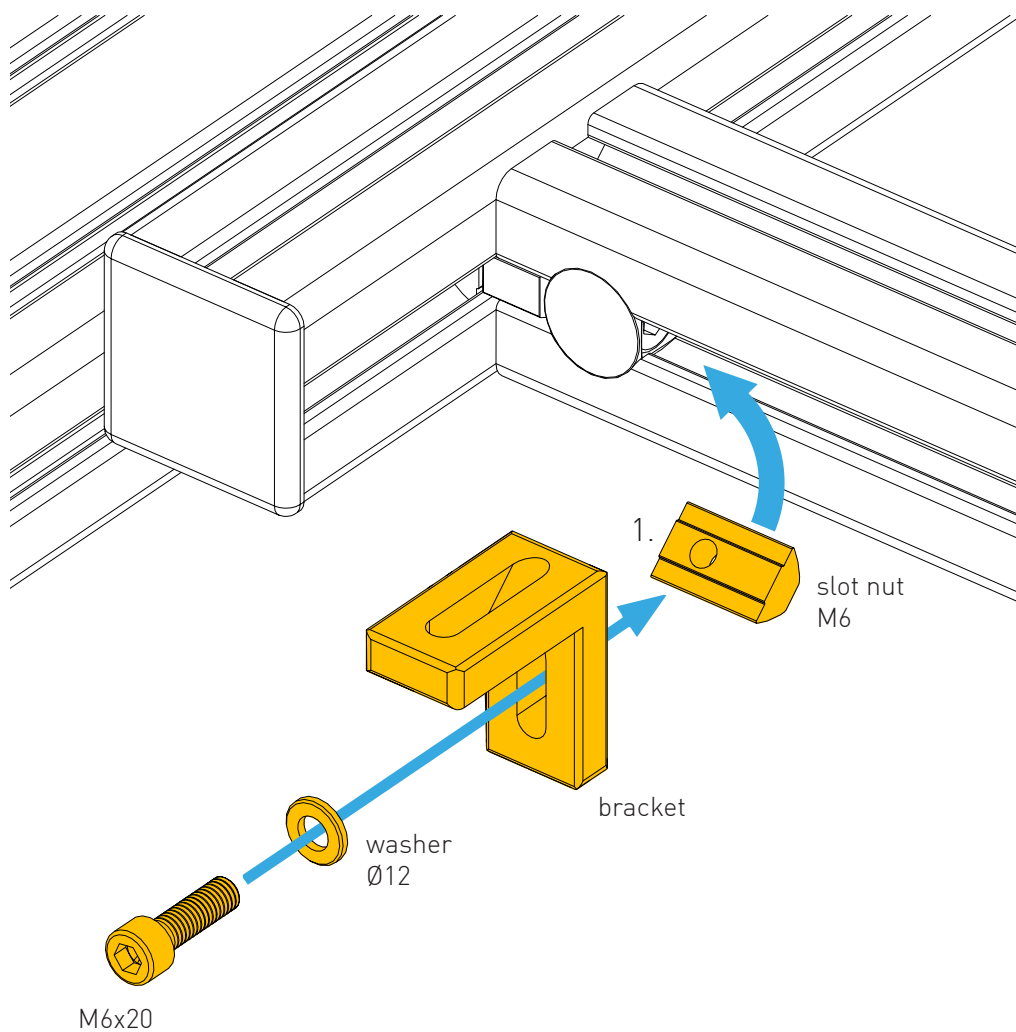

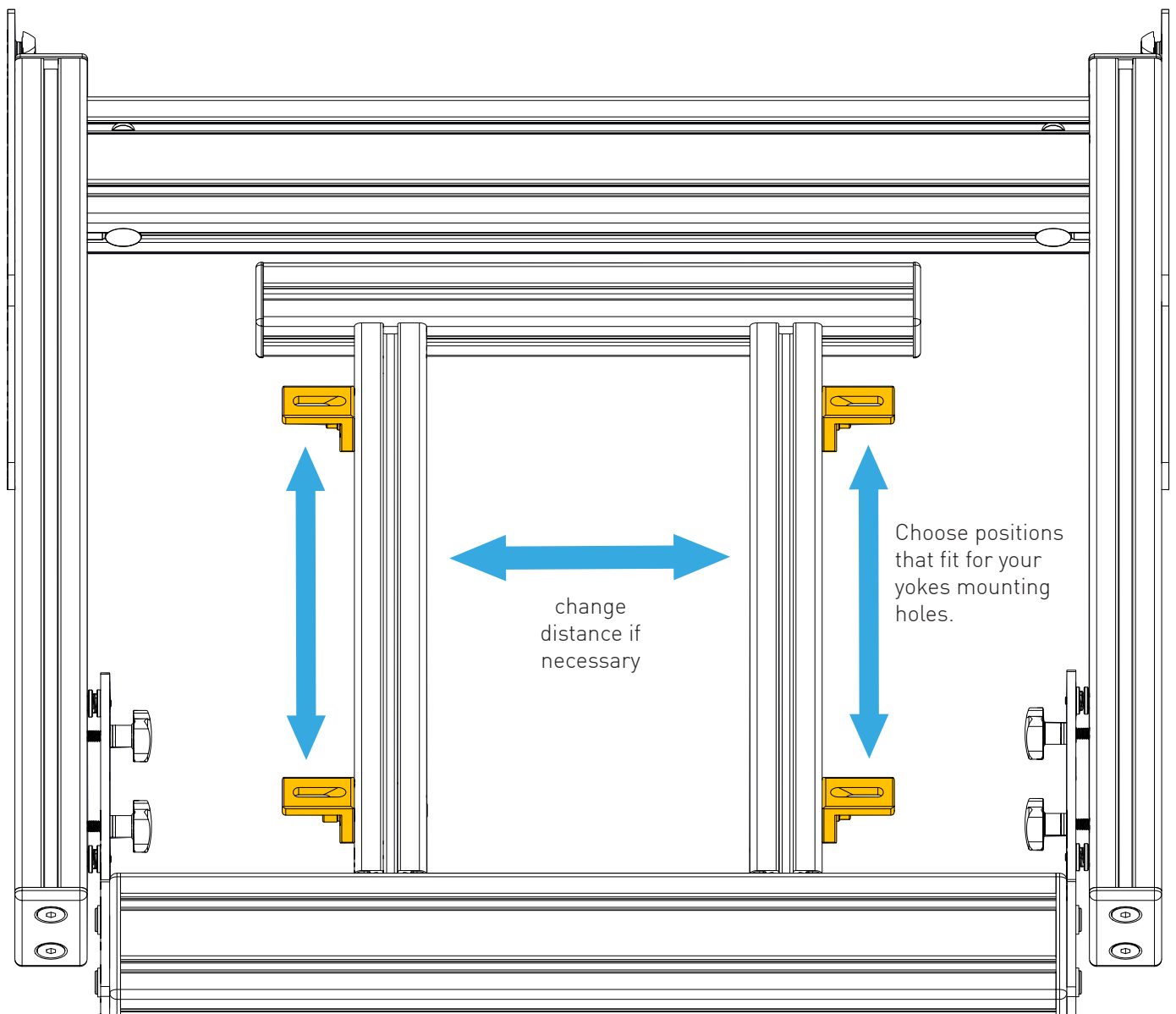

Alternative positions for the brackets

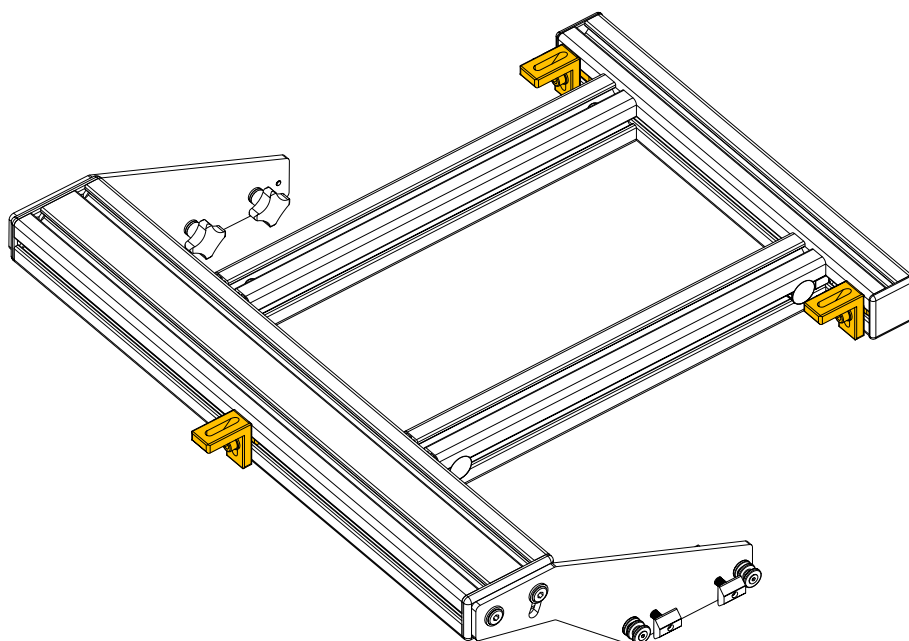
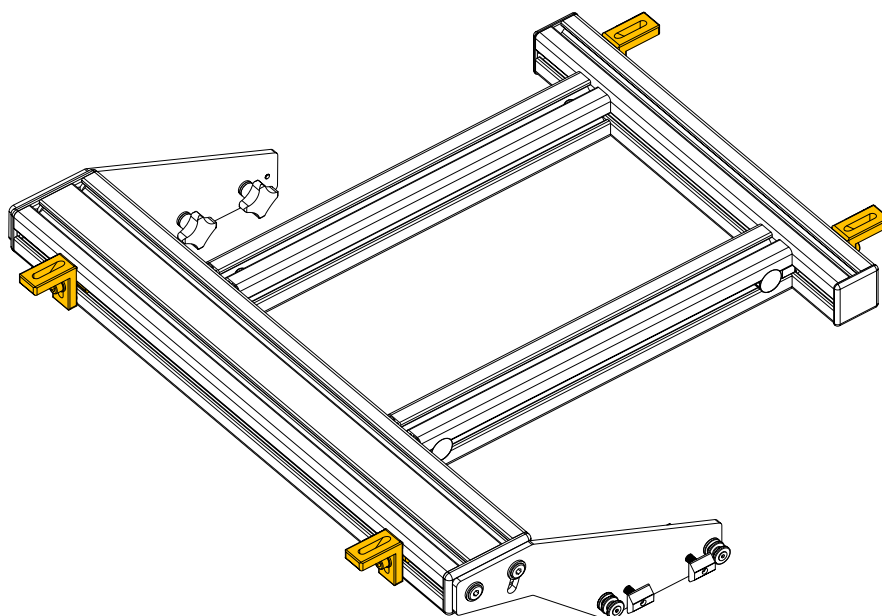
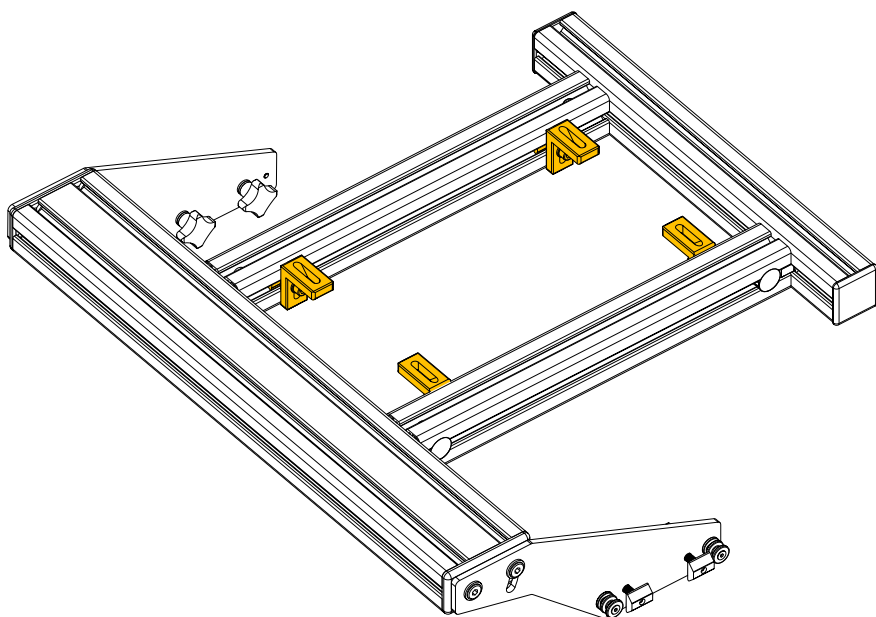

OPERATION

